

Reduction fittings nickel-plated brass increased safety Ex e II

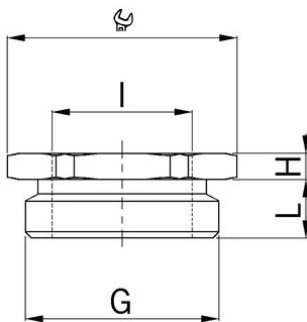

Accessories

Type approval: Reduktion MS EX

- Outer thread metric
- Inner thread metric
- with O-ring

| | |
|-----------------------|---|
| Article no: | EX3500.63.50 |
| EAN: | 7611614175614 |
| Material | Nickel-plated brass |
| O-ring | FPM |
| Operation temperature | -60°C / +100°C |
| Protection class | IP 66 / IP 68 |
| Test standard | IEC EN 60079-0 / IEC EN 60079-7 / IEC EN 60079-31 |
| Gas | II 2G Ex eb IIC Gb |
| Dust | II 2D Ex tb IIIC Db |
| Zone | Gas 1 and 2 / dust 21 and 22 |
| Certificate | SEV 15 ATEX 0151 |
| IECEx Certificate | IECEx SEV 15.0018 |
| CCC Certificate | CCC 2022322313004717 |
| Thread outside | M63x1.5 |
| Internal thread | M50x1.5 |
| Additional note | - |
| Wrench size | 70 mm |
| Dimension H | 5.5 mm |
| Dimension L | 10 mm |
| Note | - |
| Dispatch | 5 |

1 = Metric coarse-pitch thread (with VDE test report)

2 = Certificate SEV 15 ATEX 0152X / IECEx SEV 15.0019X

The norm interdicts to screw several reduction/enlarging fittings into each other!